

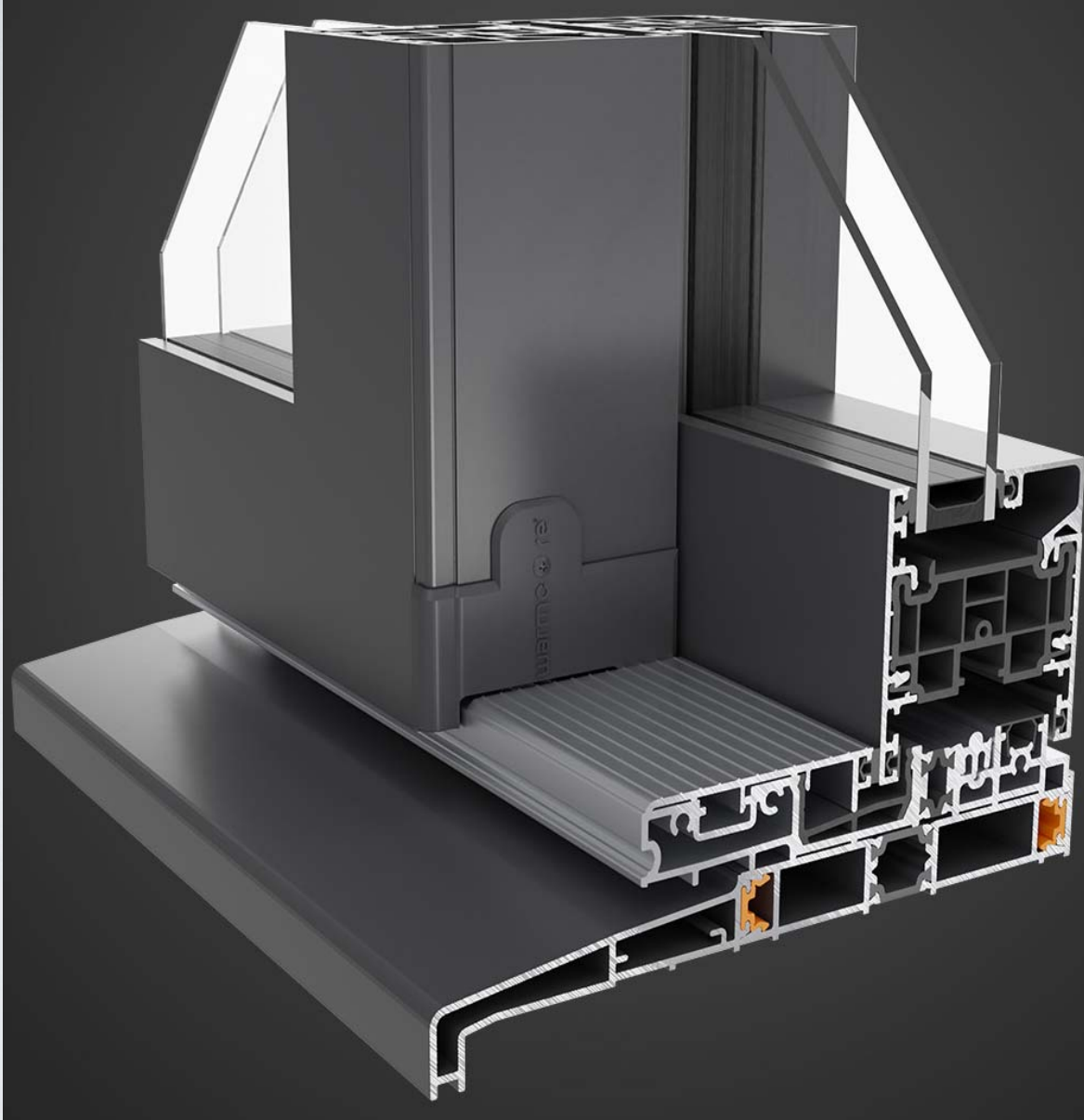

**warmcore**<sup>®</sup>  
WARM ALUMINIUM

INLINE PATIO DOOR

## WARMCORE, THE WARMER CHOICE



The traditional weakness of aluminium doors has been the aluminium itself. While a beautifully strong and hard-wearing material, aluminium is a good conductor of energy. Meaning that warmth from your home finds an easy path outside, leaving you colder and with higher heating bills. Most aluminium patio doors try to overcome this weakness by replacing a section of aluminium with a small thermal break of less conductive material to lessen this heat loss.

WarmCore took a different approach, from inception this next generation patio door was designed to be as thermally efficient as possible. Built around an award-winning, full-width thermal core – maximising the use of low conductive material – WarmCore is up to 25% more thermally efficient at keeping heat in your home than traditional aluminium doors. Yet it doesn't compromise strength as the outer faces of the profile are high grade aluminium, positioned to add the greatest structural rigidity.



# THE WARMCORE ADVANTAGE

## U-VALUE PERFORMANCE

**1.8 W/m<sup>2</sup>K**  
**U-VALUE**

Current Building Regulations Part L  
requirements for replacement doors

**1.6 W/m<sup>2</sup>K**  
**U-VALUE**

Current Building Regulations Part L  
requirements for replacement windows

**1.4 W/m<sup>2</sup>K**  
**U-VALUE**

with 28mm double glazing

**WARMCORE DOORS**

**1.0 W/m<sup>2</sup>K**  
**U-VALUE**

with 44mm triple glazing

**WARMCORE DOORS**

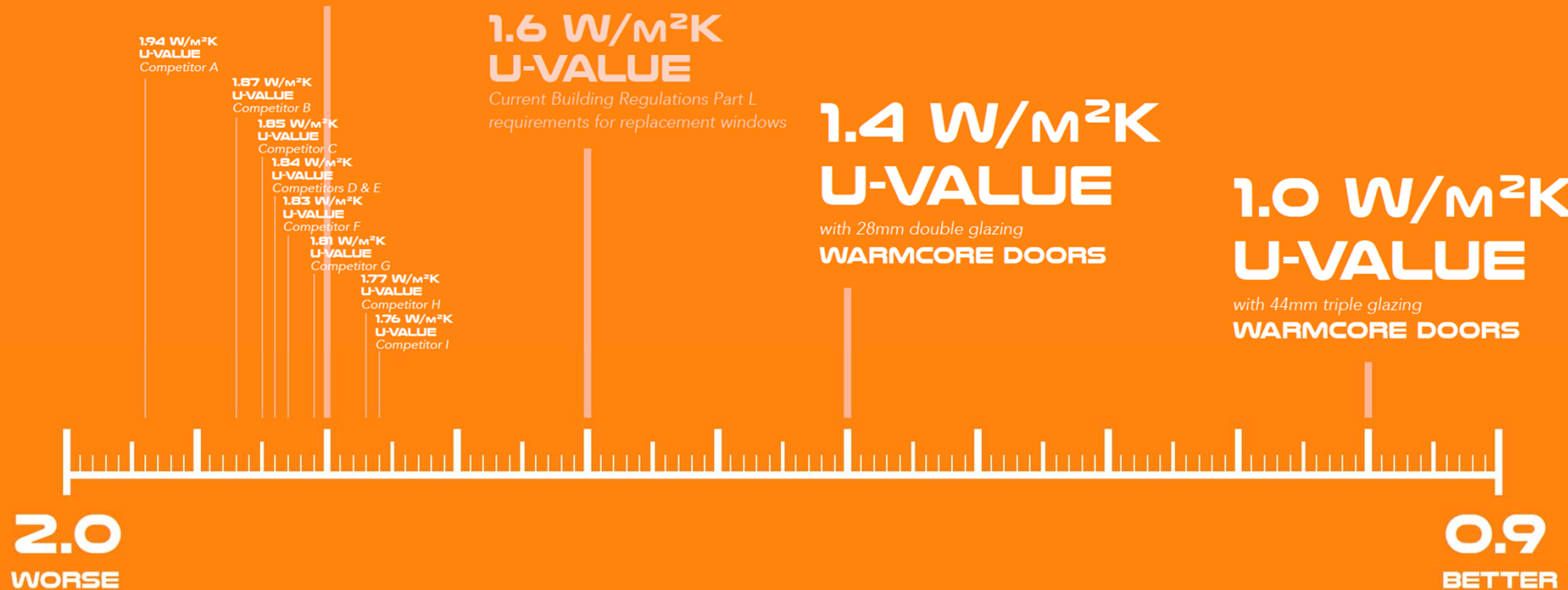

- Class Leading Thermal Performance
- 28mm & 44mm Glazing
- Double glazed U values of 1.4W/m<sup>2</sup>K
- Triple glazed U values of 1W/m<sup>2</sup>K

## INNOVATIVE HANDLE & LOCK

With an emphasis on clean, modern aesthetics we have custom designed a high quality, lift-to-lock handle, unique to WarmCore patio doors. This cutting edge handle operates the stainless steel bi-directional locks located at the top and bottom of the door which make WarmCore patio doors incredibly secure, helping protect your home and family.

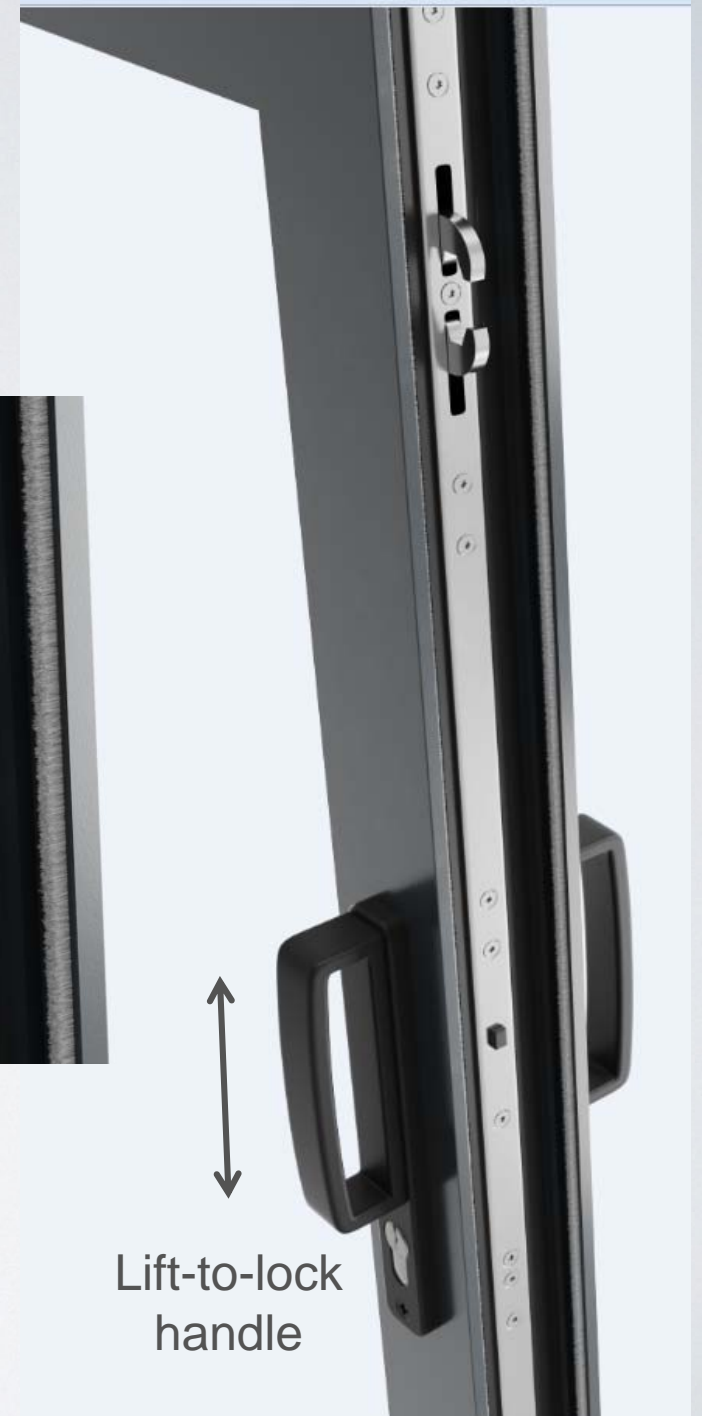

Lift-to-lock  
handle

## SAFETY FIRST - Safety Brake Mechanism

Our modern safety brakes are an optional add-on to prevent trapped fingers and unintentional slamming, particularly when children are around. Carefully considered, these built in safety brakes guarantee soft, slow opening and closing, helping to future-proof the doors from potential damage.

If the door is upgraded and fitted with a safety brake mechanism it will prevent the door from bouncing off the bump stops and act as an anti mishandling device. This can also be fitted on the lock side of the door and will act as an anti finger trap by preventing the door from being slammed shut. A gas filled strut catches the sliding sash when in motion bringing the sash to a controlled stop.





## Twin Track – Internal slider only

Twin track only due to the sashes being 70mm wide meaning the outer frame is 156mm wide to accommodate twin sash system.

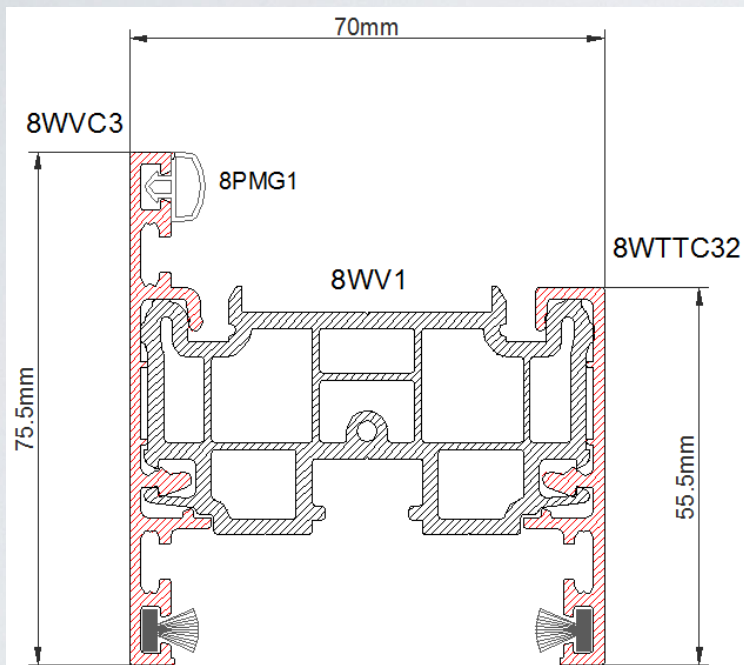

ASSEMBLED PATIO SASH

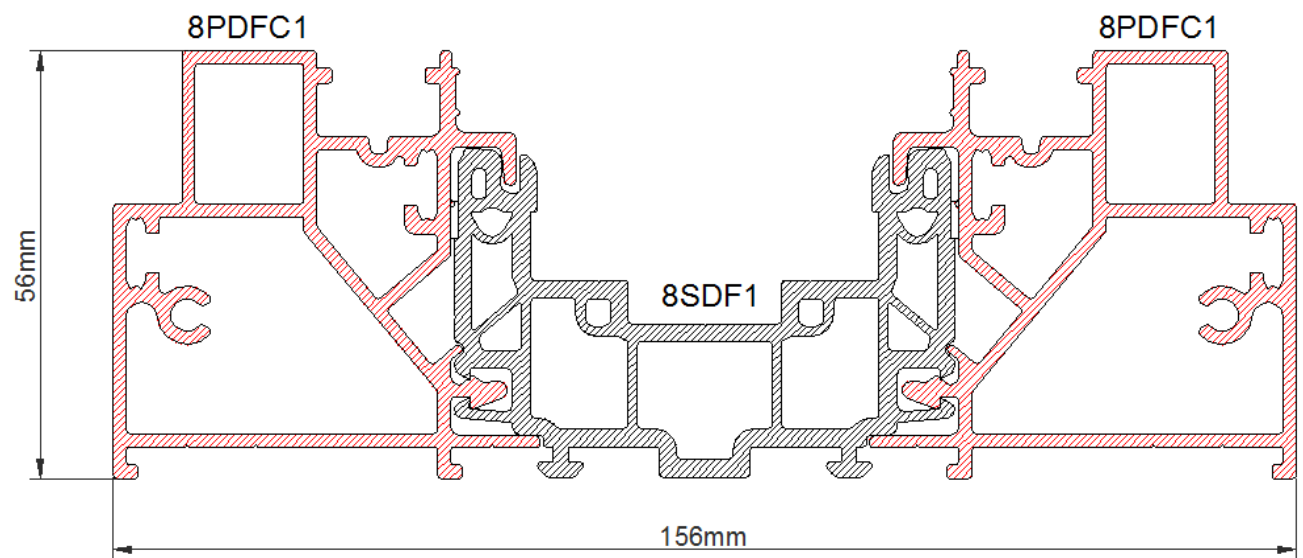

ASSEMBLED PATIO OUTERFRAME

## Flush Finish, Suites With Windows

We've brought the classic sliding patio door up to date with clean lines, a flush finish and a hard-wearing aluminium exterior. With two, three and four pane configurations available, you can choose a patio door that suits your home and living style, bringing the outside in during summer months and keeping the cold at bay during the winter.

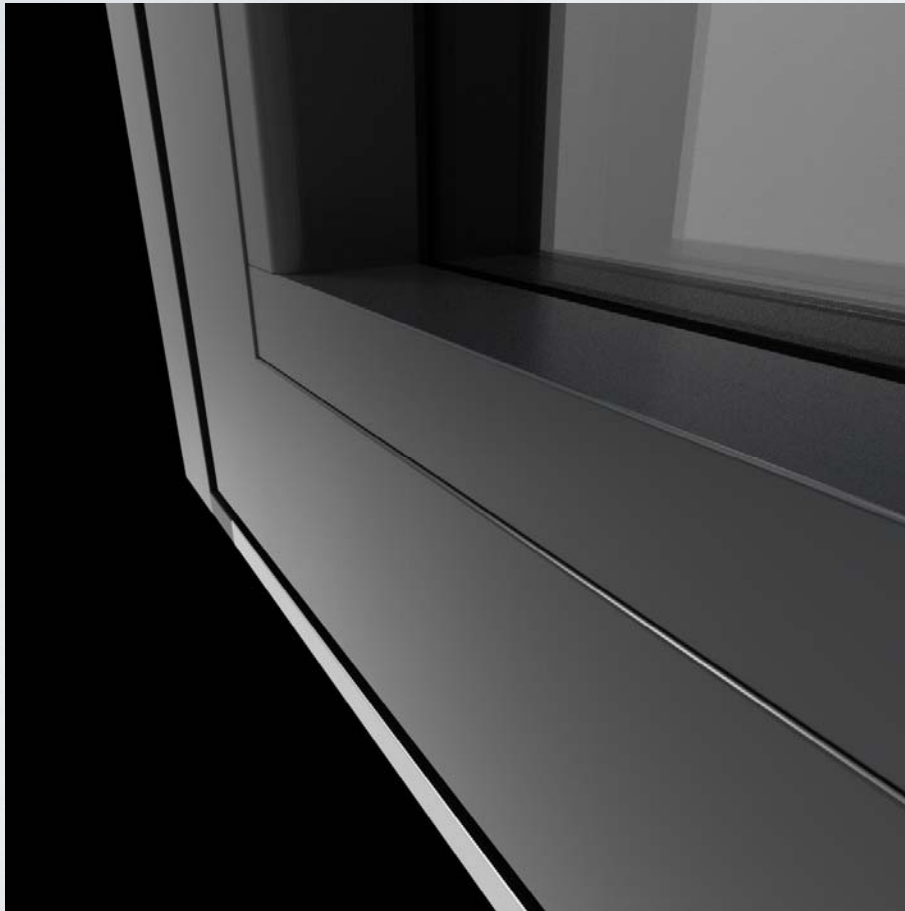

## Fully Adjustable Self-Levelling 5 Wheel Rollers

Sliding patio doors are a favourite, but old-fashioned designs are plagued with sticking and warping with age and wear. We've designed out these flaws with our innovative rollersets, with each sash running on 10 self-levelling wheels giving flawlessly smooth, reliable performance every time.

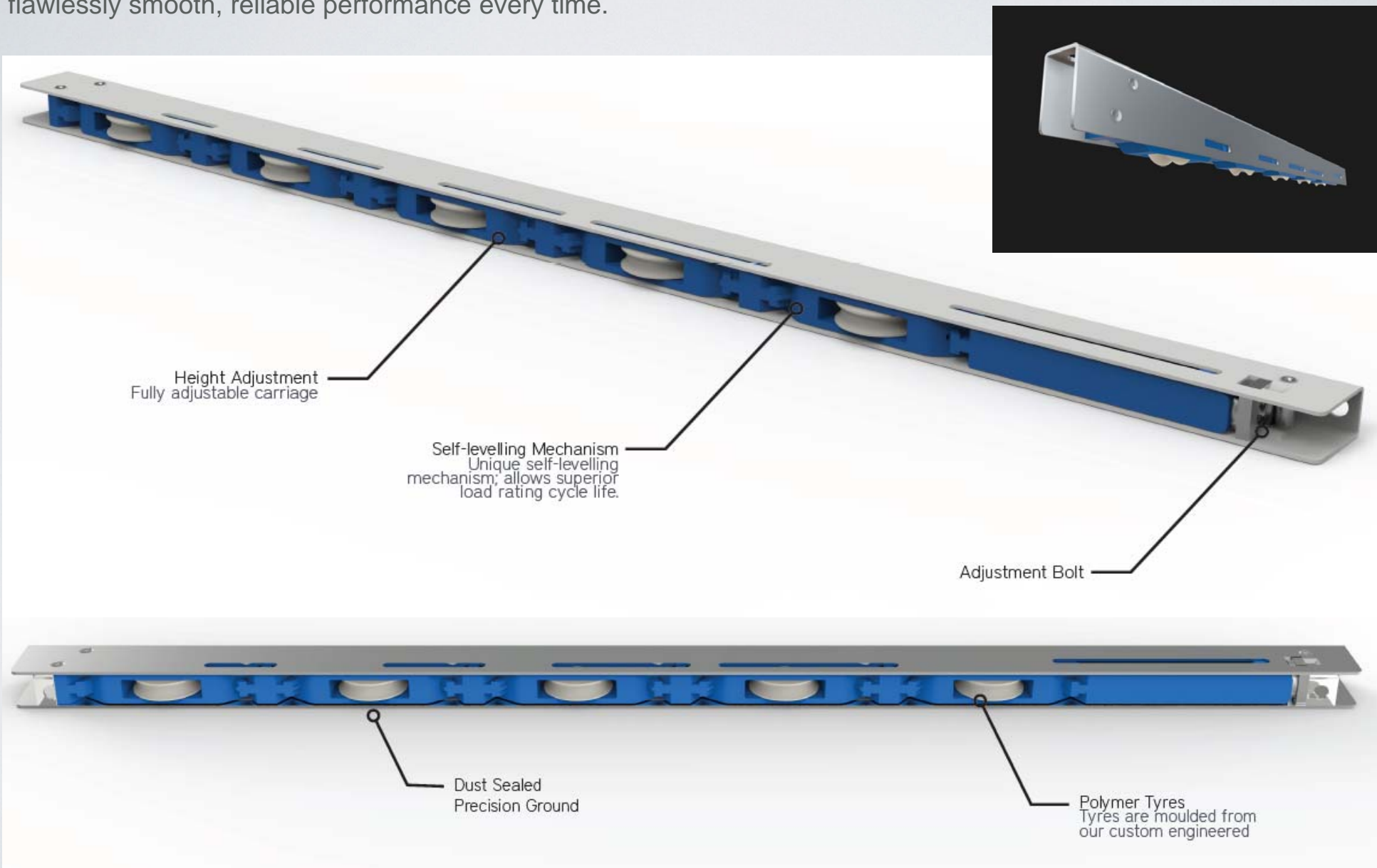



## Low Threshold Option – Thermally Broken

A choice of threshold options, which can be combined with various cill configurations.

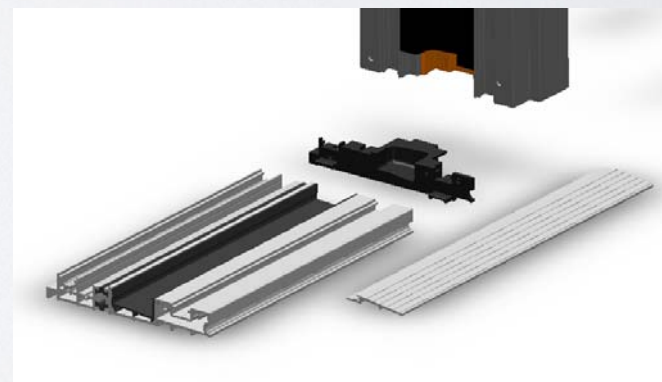
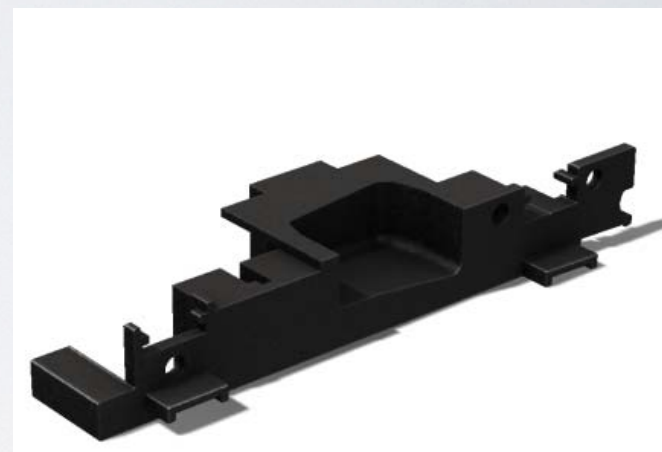

## Thermally Broken Interlock

We paid close attention to the design of the interlock and by removing the usual full length aluminium interlock strip. We replaced this with a thermally efficient foam profile to greatly improve thermal performance. We then addressed the security aspect by designing and fitting 2 pairs of 3mm stainless steel anti separation brackets at the top and bottom of each sash.

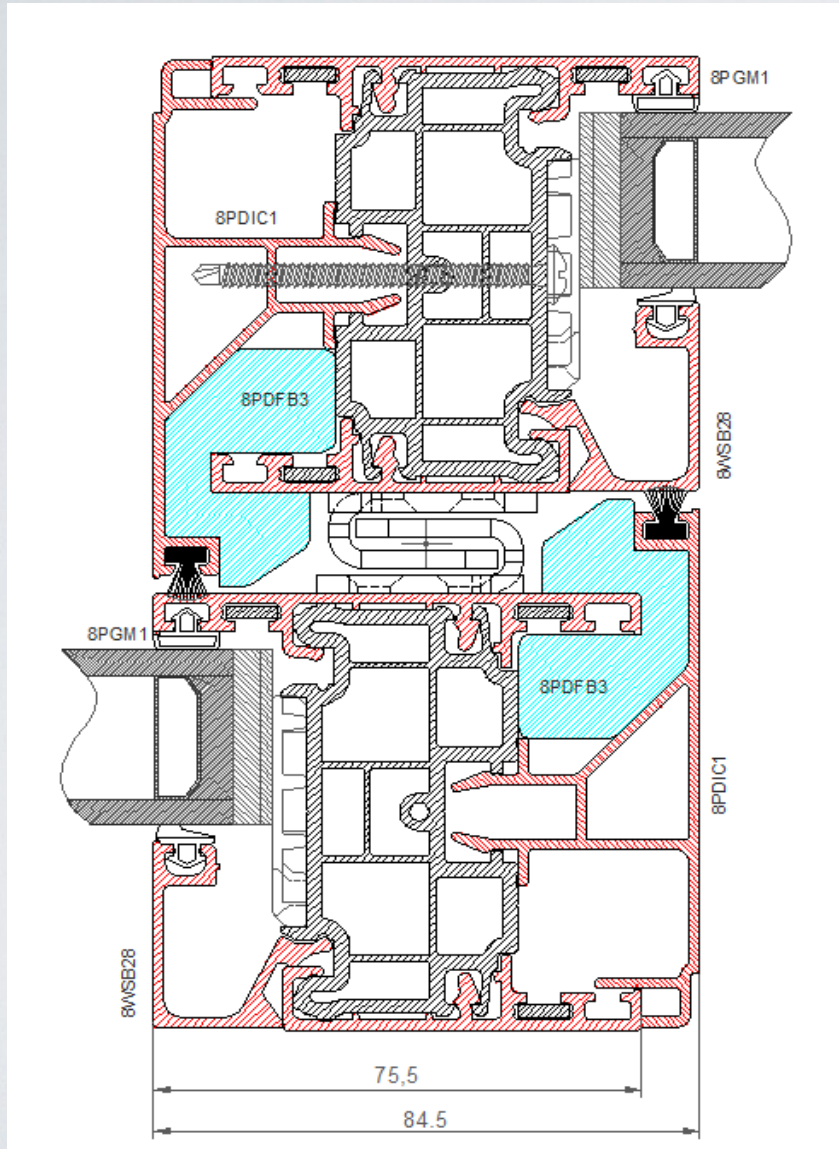



- Utilising cores from the Bi-fold & Window suite
- Existing Aluminium clads & Beads from the window suite are used for the door sash
- Adding to the WarmCore Product Range
- Bespoke Hardware
- Pre Rolled Outerframe – Providing existing Window WarmCore Fabricators low set up cost - No roller Required
- Dedicated Sill in widths of 210mm or 240mm using sill noses from the window suite

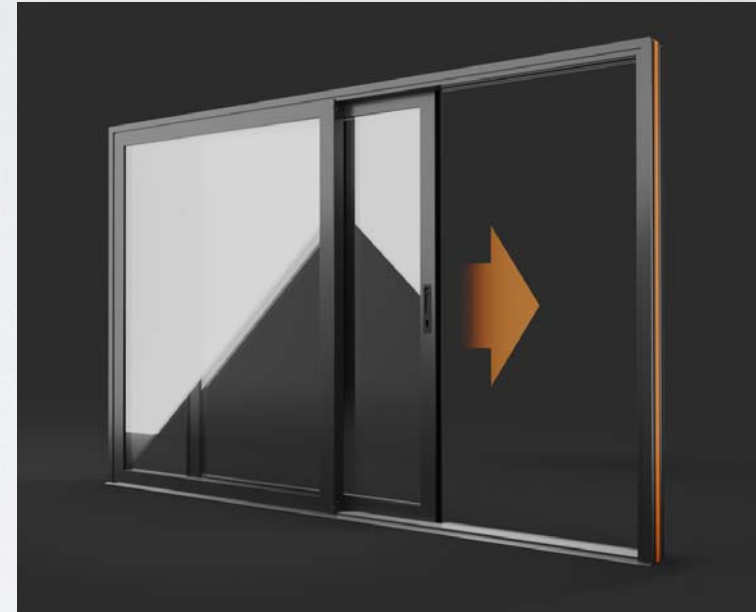



## MIN/MAX FRAME SIZES

2-Pane		3-Pane		4-Pane	
min width	1500 mm	min width	2238 mm	min width	2906 mm
max width	4000 mm	max width	6000 mm	max width	6000 mm
min height	1750 mm	min height	1750 mm	min height	1750 mm
max height	2400 mm	max height	2400 mm	max height	2400 mm

*Above sizes are frame only*

## DOOR CONFIGURATIONS

**All doors are viewed from outside.**

**X = Slider    O = Fixed Panel**

Please select which configuration is required by selecting with the tick box on the diagrams shown.

**All doors are internal sliders**

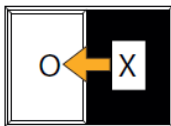
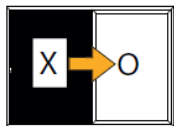
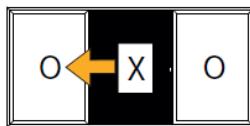
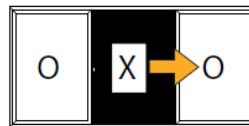
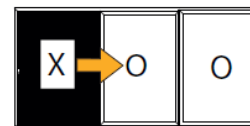
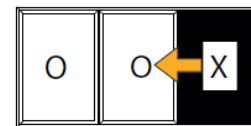
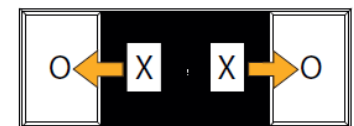
☐

☐

☐

☐

☐

☐

☐